



THE
SHELBOURNE

Events

For almost 200 years, The Shelbourne has been Dublin's most distinguished and distinctive meeting place.

From the glittering highlights of the social season to impressive and memorable corporate meetings and events, The Shelbourne has always offered a spectacular setting for friends and colleagues to gather on their most important days. The elegant meeting rooms and suites are filled with historical significance, character and charm, while also offering every modern amenity, comfort and technology. Whether you are planning a small get-together or a major business conference, The Shelbourne and its dedicated staff will ensure that your event is a resounding success and a happy memory for all of your guests.



Contact our Sales Team on
Tel: + 353 1 663 4500
ak.dubdt.sales@autographhotels.com
Visit [theshelbourne.com](https://www.theshelbourne.com) to download printable floor plans



Meetings & Events at The Shelbourne

- Dublin's largest 5 star luxury hotel, founded in 1824
- Located in the heart of Dublin city centre, the best of the city is on your doorstep – restaurants, bars, theatres, museums and shopping
- Superb choice of restaurants and lounges
- 30 minutes from Dublin Airport
- 10 state of the art banqueting suites and 9 breakout rooms 988 sq. m. (over 10,000 sq. ft.) of total meeting space
- All first floor meeting suites enjoy natural daylight, ceiling heights over 4 metres and views overlooking the magnificent St. Stephen's Green
- High-speed internet access and advanced audio-visual facilities
- The Irish Constitution was drafted in The Constitution Suite

Facilities

- 265 luxurious guest rooms and suites
- LCD flat screen TV
- Elegant marble bathrooms
- High-speed internet access
- Laptop safe
- US, European and Irish multi-sockets
- Complimentary shoe shine
- Individual climate control
- Health Club 18m pool
- Spa and Salon

Ground Floor

The Shelbourne’s iconic ballroom has hosted many legendary events. The Great Room features a private entrance, historic reception rooms, ornate décor, elegant lighting and audio-visual equipment.

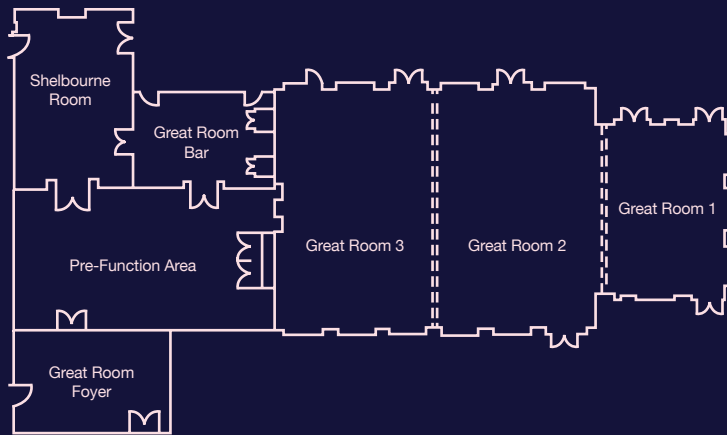

First Floor

The meeting rooms on The Shelbourne’s first floor provide an elegant and atmospheric backdrop for meetings, private dining, and small receptions. Named to reflect the soul and history of the hotel, each boasts beautiful views of St. Stephen’s Green, and each is individually decorated in keeping with its unique character. Most renowned is The Constitution Suite, where Ireland’s first constitution was drafted in 1922 under the chairmanship of Michael Collins. As a counterpoint to their historical décor, each room can offer high speed internet access and advanced audio-visual facilities, available upon request.

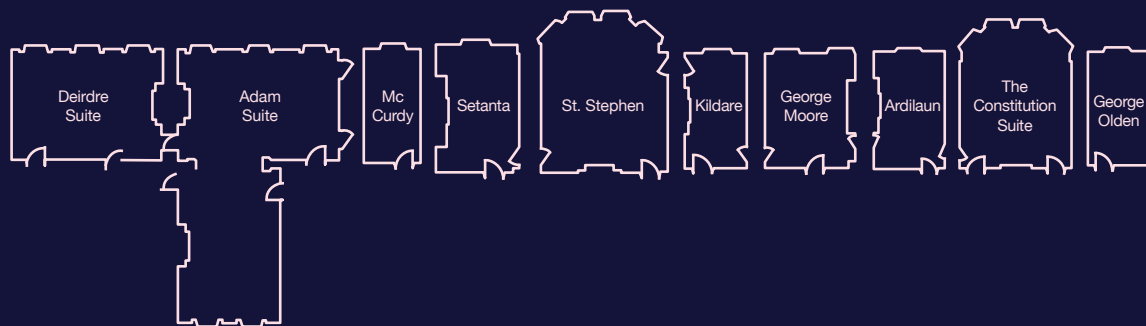

Planning your Event with The Shelbourne

A five star event calls for five star service. Our expert events team will help you plan the perfect experience for all of your guests or delegates and ensure that the day runs smoothly, with no detail left to chance. For more information on planning your business event or to make a booking contact our dedicated sales team.

	Natural Light	SQM	Length	Width	Height	Theatre (front projection)	Theatre (back projection)	Boardroom	U-Shape	Hollow Square	Classroom	Cabaret (front projection)	Cabaret (back projection)	Cocktail Reception	Seated Dinner
ADAM	YES	162.99	16.5	9.87	4.4	80	-	26	24	30	60	49	-	90	84
DEIRDRE	YES	70.41	9.93	7.08	4.4	48	-	22	20	24	24	28	-	50	44
MCCURDY	YES	19.77	6.55	3.01	4.3	-	-	10	-	-	-	-	-	-	-
SETANTA	YES	35.84	7.68	4.66	4.31	12	-	12	-	-	-	-	-	20	12
ST. STEPHEN	YES	73.71	9.63	7.65	4.27	60	-	26	24	30	21	28	-	60	48
KILDARE	YES	26.42	7.6	3.47	4.31	12	-	10	-	-	-	-	-	20	10
GEORGE MOORE	YES	42.17	7.56	5.57	4.25	18	-	18	-	-	12	14	-	40	24
ARDILAUN	YES	29.69	7.43	3.99	4.4	12	-	12	-	-	-	-	-	20	12
CONSTITUTION	YES	67.94	9.49	7.15	4.27	-	-	24	-	-	-	-	-	-	22
GEORGE OLDEN	YES	27.1	6.94	3.9	4.2	-	-	12	-	-	-	-	-	-	-
1824 BAR	YES	51.01	7.31	6.7	4.4	-	-	-	-	-	-	-	-	35	-
THE TERRACE	YES	156.59	13.3	12.3	-	-	-	-	-	-	-	-	-	60	-
THE GREAT ROOM	NO	462.13	28.87	16	3.91	450	380	86	84	60	252	240	198	550	348
SALON 1 (MIRROR)	NO	89.65	7.83	11.44	3.91	84	-	-	-	-	60	-	-	100	80
SALON 2 (MID)	NO	168.56	10.53	16.02	3.91	176	-	-	-	-	96	-	-	200	110
SALON 3 (STAIRS)	NO	159.97	9.99	16.02	3.91	176	-	-	-	-	96	-	-	200	110
SHELBOURNE ROOM	YES	71.12	10.34	6.87	4.2	40	-	24	20	-	24	21	-	50	48

